



2015 NORTH AMERICAN DDI USER CONFERENCE

{Research Data Management:
Enhancing Discoverability
with Open Metadata Standards}

April 8-10, 2015
in Madison, WI



Hosted by the **UW-Madison Institute on Aging**

Our Sponsors:

National Archive of Computerized Data on Aging

[www.icpsr.umich.edu/
icpsrweb/NACDA/](http://www.icpsr.umich.edu/icpsrweb/NACDA/)

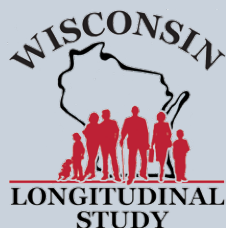

Welcome!

On behalf of the Institute on Aging at the University of Wisconsin-Madison, I am delighted to welcome you to the 3rd North American Data Documentation Initiative (DDI) User Conference. The theme of this year's meeting – “Enhancing Discoverability with Open Metadata Standards” – could not be more timely or important, given the growth of large-scale, complex data resources.

A major focus of our Institute is the MIDUS (Midlife in the U.S.) national study. It is an enormous enterprise whose broad objective is to integrate the wide array of influences that affect people's health as they age from early adulthood to later life. The task requires collecting in-depth data on demographic, behavioral, psychological, social, biological, and neurological factors. As such, we are assembling a massive, cross-time dataset (with variables on over 12,000 U.S. individuals) and it is growing.

Under Barry Radler's masterful leadership, DDI has transformed the usability and discoverability of the MIDUS investigation. The reception from the scientific community has been immense– MIDUS is the most frequently downloaded dataset at the National Archive for Computerized Data on Aging at ICPSR and has generated over 600 publications. We credit DDI for a large portion of that popular usage.

High quality metadata and infrastructure support (i.e., DDI) has been central to the success of MIDUS. I therefore wish you a fruitful and productive conference in addressing the challenges and opportunities of using DDI to enhance research data management. The work you are doing is essential for the complex scientific challenges that define our era.

I hope you enjoy the conference and our lovely city,

Carol D. Ryff, Ph.D.
Director, Institute on Aging
Hilldale Professor of Psychology
Principal Investigator, MIDUS
University of Wisconsin-Madison



Conference Schedule

<Wed April 8>		Training Sessions
7:30	8:30	Registration & Packet Pick-up <i>(See electronic kiosk in Pyle Center lobby for location.)</i>
8:15	9:00	Pastries, Fruit, Coffee, Networking
		MORNING WORKSHOP - Room B
9:00	12:00	<p>Discover the Power of DDI Metadata</p> <p>This workshop is appropriate for anyone who is responsible for managing microdata of individuals or organizations and wondered how metadata could streamline their research.</p> <p><i>Instructor: Jane Fry, Carleton University, Ottawa, Ontario</i></p>
12:00	13:30	Lunch – On Your Own
		AFTERNOON WORKSHOP - Room B
13:30	16:30	<p>Open Data and Metadata Management</p> <p>This workshop focuses on the practical packaging of open data and metadata, in particular for statistical datasets. Participants will learn about the benefits of complementing ASCII text data files with DDI-XML for the publication, sharing, and long term preservation of data, and how, when combined with relevant scripts and programs, such approach provides a powerful packaging system for the effective delivery of open data.</p> <p><i>Instructors: Andrew DeCarlo & Arofan Gregory, Metadata Technology North America, Inc.</i></p>
18:00		No-Host Dinner (Location TBD)



<Thur April 9>		Main Conference - Day 1	
8:00	8:30	Registration & Packet Pick-up <i>(See electronic kiosk in Pyle Center lobby for location.)</i>	
8:00	8:30	Pastries, Fruit, Coffee, Networking	
		PYLE CENTER - Room A	
8:45	9:00	Introduction: Dr. Barry Radler <i>Institute on Aging, UW-Madison</i> Welcome: Dr. Marsha Mailick <i>Vice Chancellor for Research and Graduate Education, UW-Madison</i>	
9:00	10:00	Keynote Address: From ‘Data Discoverability’ to ‘Data Navigability’ Dr. Tito Castillo <i>Founder and Managing Director, Xperimint Ltd</i>	
		CONCURRENT SESSION - Room A	CONCURRENT SESSION - Room B
10:15	10:45	Data Capture: Tracking Data from Source to Results <i>Wendy L. Thomas, Minnesota Population Center</i>	University Data Policies and Data Services <i>Kristin Briney, UW-Milwaukee</i>
10:45	11:45	International Clinical Research Collaborations using DDI Lifecycle: CHARM’s Growing Pains <i>David K. Johnson, University of Kansas</i>	Research Data Services at the University of Wisconsin-Madison <i>Brianna Marshall, Trisha Adamus, & Elliott Shuppy; UW-Madison</i>
12:00	13:30	Lunch – On Your Own	

<Thur April 9>		Main Conference - Day 1 continued...	
		PYLE CENTER - Room A	
13:30	14:00	Supporting Extended Citations in DDI4 <i>Larry Hoyle & Mary Vardigan, Institute for Policy & Social Research and ICPSR</i>	
14:00	14:30	Data Discoverability in Public Health <i>Arofan Gregory, Tito Castillo, Samuel Moore, Brian Hole, Christiana McMahon, Spiros Denaxas, Veerle Van Den Eyden, Herve' L'Hours, Lucy Bell, Jack Kneeshaw, Matthew Woollard, Chifundo Kanjala, Gareth Knight, & Basia Zaba; Open Data Foundation</i>	
14:30	15:00	Break – Sodas, Snacks	
		CONCURRENT SESSION - Room A	CONCURRENT SESSION - Room B
15:00	15:30	Overviewing the Translating Research in Elder Care Monitoring System (TMS) Data Platform <i>James M. Doiron, Health Research Data Repository, University of Alberta; Andrew DeCarlo, Metadata Technologies North America, Inc.; & Shane McChesney, Nooro Online Research</i>	Data Management Module: a New Extension for the Rogatus System <i>Ingo Barkow, DIPF - German Institute for International Educational Research</i>
15:30	16:00		Documenting Spreadsheets with Colectica for Excel <i>Dan Smith, Colectica</i>
		PYLE CENTER - ALUMNI LOUNGE (1st Floor Overlooking Lake Mendota)	
17:00	18:00	Cash Bar	
18:00	20:00	Dinner	



<Fri April 10>		Main Conference - Day 2	
8:00	9:00	Pastries, Fruit, Coffee, Networking – Pyle Center	
		PYLE CENTER - Room A	
9:00	10:00	Plenary Session: Discovering Standards Dorothea Salo <i>Faculty Associate, School of Library and Information Studies, UW-Madison</i>	
10:15	11:15	A Next Generation, Reusable, Web-based Data Catalog <i>Jeremy Iverson, Colectica; & Barry Radler, Institute on Aging, UW-Madison</i>	
		CONCURRENT SESSION - Room A	CONCURRENT SESSION - Room B
11:15	11:45	Starting in the Middle: The Wisconsin Longitudinal Study and DDI <i>Carol Lynn Roan, UW-Madison</i>	Crowdsourcing DDI Development: New Features from the CED2AR Project <i>Benjamin Perry, Venkata Kambhampaty, Kyle Brumsted, Lars Vilhuber, & William C. Block; Cornell Institute for Social & Economic Research</i>
12:00	13:30	Hosted Lunch at the Pyle Center	
13:30	14:00	Documenting the Vietnam Era Twin Study of Aging <i>Carol Franz, University of California-San Diego</i>	An Open Source, DDI-Based Data Curation System for Social Science Data <i>Jeremy Iverson, Colectica</i>
14:00	14:30	First Results from the Survey on Metadata Management in the Educational Sciences <i>Ingo Barkow, DIPF - German Institute for International Educational Research</i>	Connecting the Dots with DDI <i>Michelle Edwards, Cornell Institute for Social and Economic Research (CISER)</i>
14:30	15:00	Break – Sodas, Snacks	
		PYLE CENTER - Room A	
15:00	15:30	DDI Moving Forward: Update, Feedback, and Suggestions for the Project The next generation of the DDI will use unified modelling language to simplify the DDI standard, broaden its focus to new research domains, and make it expressible in technologies beyond XML.	
15:30	16:00	Marketing and Generating Partnerships Group Discussion A conversation with the DDI Marketing and Partnerships group about tapping into user networks and developing a more formal mechanism to gauge user needs, frustrations, and challenges.	
16:00	16:30	Plenary Session: Conference Wrap-Up and Future of NADDI	

↑ N
toward lake

3rd Floor

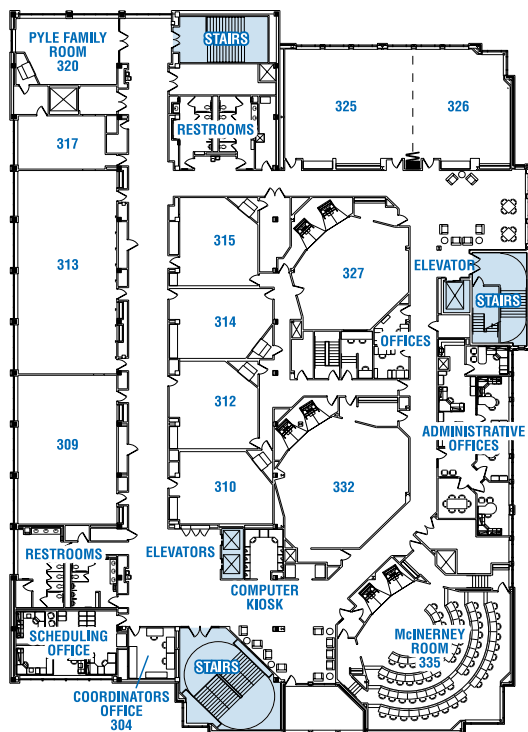

2nd Floor

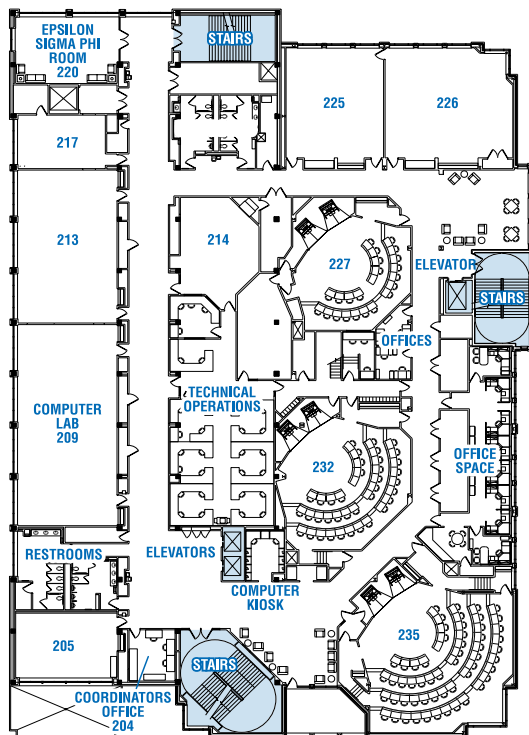

1st Floor

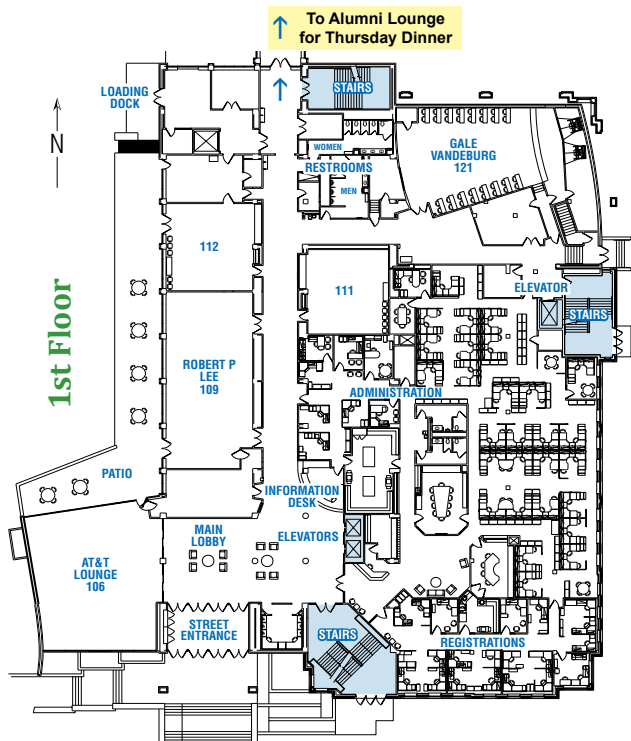

Lower Floor

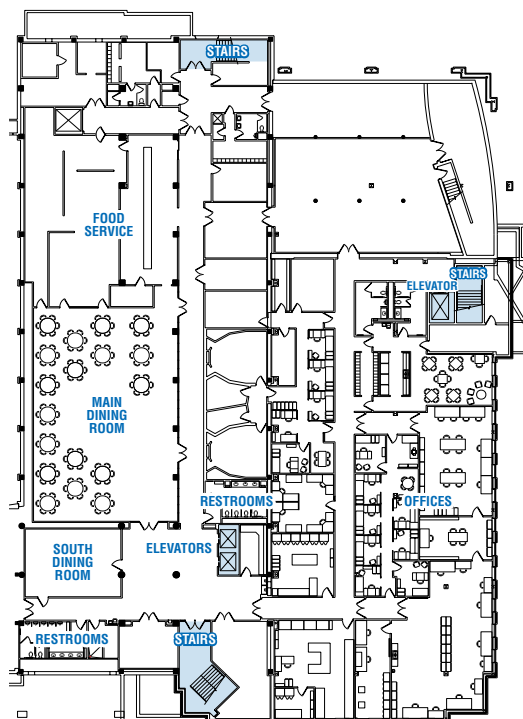

www.ssc.wisc.edu/naddi2015
Madison, WI



*Providing university
researchers and faculty with
high quality survey methods
and data collection
since 1987.*